

**Dimensions mm[inch]**  
tolerances according to DIN ISO 2768-m  
Toleranzen gem. DIN ISO 2768-m

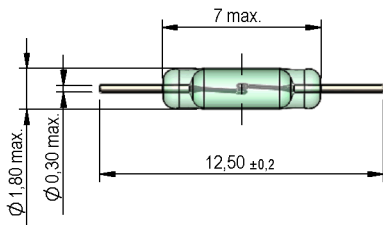

**Isometric**  
Scale 2:1  
Maßstab 2:1

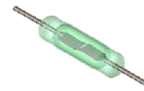

**Recommended PCB Pad Layout**

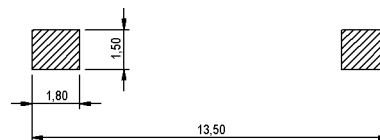

**Solder Reflow Profile**

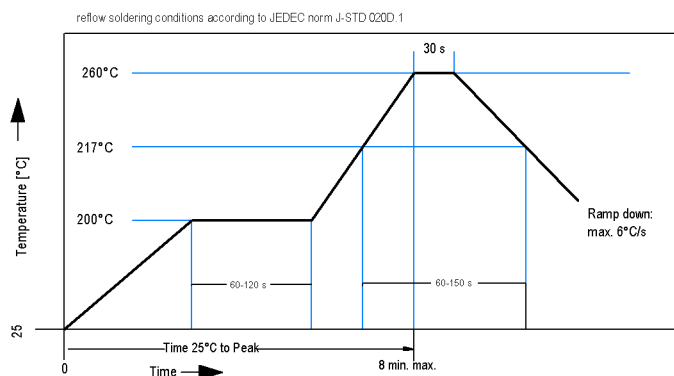

**Packaging**

(4001350017)

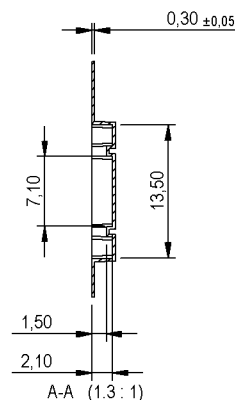
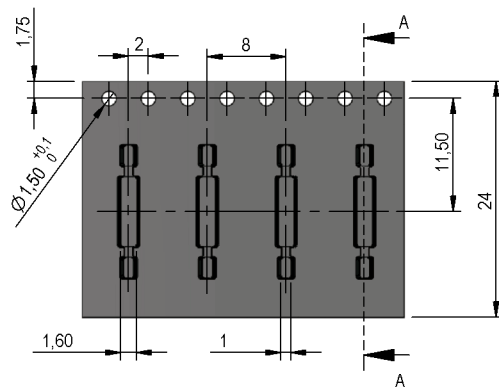



Europe: +49 / 7731 8399 0

| Email: info@standexmeder.com

Item No.:

USA: +1 / 508 295 0771

| Email: salesusa@standexmeder.com

**9233801015**

Asia: +852 / 2955 1682

| Email: salesasia@standexmeder.com

Item:

**MK23-80-B-1**

| Magnetic properties                   | Conditions  | Min    | Typ | Max | Unit |
|---------------------------------------|---|--------|-----|-----|------|
| Pull-In excitation (modified contact) | Reed switch modified<br>phys. conditioned tolerance of +/- 1 AT | 17     |     | 29  | AT   |
| Test-Coil                             | Reed switch modified  | KMS-22 |     |     |      |
| Pull-In in milliTesla (modified conta | MS150 -<br>phys. caused tolerance +/- 0,1mT                     | 1,7    |     | 2,1 | mT   |

| Contact data 80            | Conditions   | Min     | Typ | Max | Unit |
|----------------------------|--|---------|-----|-----|------|
| Contact-No.                |  | 80      |     |     |      |
| Contact-form               |  | A       |     |     |      |
| Contact-material           |  | Rhodium |     |     |      |
| Contact-rating             | Any DC combination of V & A<br>not to exceed their individual max.'s |         |     | 10  | W    |
| Switching voltage          | DC or Peak AC  |         |     | 170 | V    |
| Switching current          | DC or Peak AC  |         |     | 0,5 | A    |
| Carry current              | DC or Peak AC  |         |     | 0,5 | A    |
| Contact resistance static  | Measured with 40% overdrive<br>Start Value                           |         |     | 200 | mOhm |
| Contact resistance dynamic | Maximum value 1,5 ms after excitation<br>Start Value                 |         |     | 250 | mOhm |
| Insulation resistance      | RH <45 %, 100 V test voltage   | 1       |     |     | GOhm |
| Breakdown voltage          | according to IEC 255-5   | 150     |     |     | VDC  |
| Operate time incl. bounce  | measured with 40% overdrive  |         |     | 0,6 | ms   |
| Release time               | measured with no coil excitation                                     |         |     | 0,1 | ms   |
| Capacity                   |  |         | 0,2 |     | pF   |

| Environmental data    | Conditions                  | Min | Typ | Max | Unit |
|-----------------------|-----------------------------|-----|-----|-----|------|
| Shock                 | 1/2 sine wave duration 11ms |     |     | 30  | g    |
| Vibration             | from 10 - 2000 Hz           |     |     | 20  | g    |
| Ambient temperature   |                             | -40 |     | 130 | °C   |
| Storage temperature   |                             | -55 |     | 130 | °C   |
| Soldering temperature | wave soldering max. 5 sec.  |     |     | 260 | °C   |

| General data | Conditions | Min                   | Typ | Max | Unit |
|--------------|------------|-----------------------|-----|-----|------|
| Packaging    |            | Tape & Reel 2500 pcs. |     |     |      |

Modifications in the sense of technical progress are reserved

Designed at: 06.04.09 Designed by: AKELLER

Approval at: 16.04.09 Approval by: RKAMP

Last Change at: 16.07.14 Last Change by: WKOVACS

Approval at: 16.07.14 Approval by: AWEBER

Version: 03