

Dimensions mm[inch]
 tolerances acc. to DIN ISO 2768-m
 Toleranzen gem. DIN ISO 2768-m

Isometric
 Scale 1:2
 Maßstab 1:2

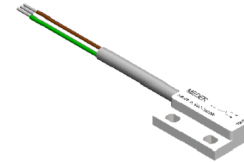

Housing

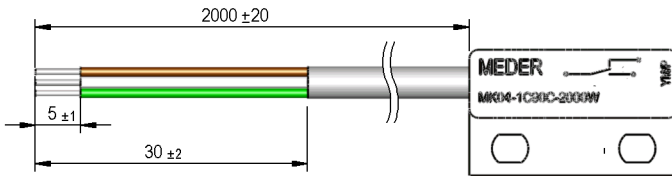
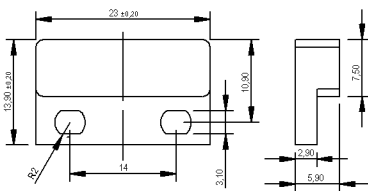

Cable

round cable LIYY 3x0,14qmm
 colour of wires, white, brown, green
 RundkabelIYY 3x0,14qmm
 Aderfarben, weiß, braun, grün

Terminals/Connector

Ends tinned
 Enden verzinkt

Schematic

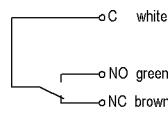

Marking

according to EN60062/factory code
 gem. EN60062/Fertigungsstätte

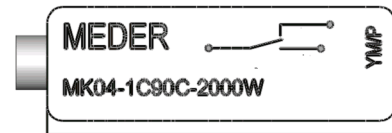

Magnetic properties	Conditions	Min	Typ	Max	Unit
Pull-In	at 20°C	42		64	AT
Test equipment		KMS-14			

Special Product Data	Conditions	Min	Typ	Max	Unit
Contact - form		Form C - Changeover			
Contact rating	Any DC combination of V & A not to exceed their individual max.'s			10	W
Switching voltage	DC or Peak AC/ with 40% overdrive			175	V
Switching current	DC or Peak AC/with 40% overdrive			0,5	A
Carry current	DC or Peak AC/ with 40% overdrive			1	A
Sensor-resistance	measured with 40% overdrive			700	mOhm
Housing material		PBT glass fibre reinforced			
Case colour		nature			
Sealing compound		Polyurethan			

Environmental data	Conditions	Min	Typ	Max	Unit
Operating temperature	cable not moved	-30		80	°C
Operating temperature	cable moved	-5		80	°C
Storage temperature		-30		80	°C

Cable specification	Conditions	Min	Typ	Max	Unit
Cable type		round cable			
Cable material		PVC			
Cross section		0,14 mm²			

General data	Conditions	Min	Typ	Max	Unit
Mounting advice		over 5m cable, a series resistor is recommended.			
Mounting advice		Decreased switching distances by mounting on iron.			
Mounting advice		Magnetically conductive screws must not be used.			
Tightening torque	Screw M3 ISO 1207 Disk ISO 7089			0,5	Nm